

COVERS  
15,000 SQ. FT.

# ACE GREEN TURF®

## COVERS 15,000 SQUARE FEET

7229560

Net Wt. 42 lbs.  
(19.1 kg)

ACE GREEN TURF.

Weed and Feed

Para Desherbar y Alimentar

30-0-4

Net Wt. 42 lbs.  
(19.1 kg)

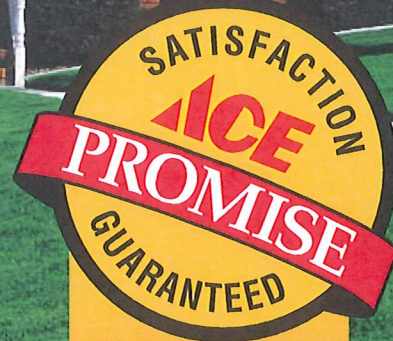

30-0-4

Weed and Feed

Para Desherbar y Alimentar

ACE GREEN TURF.

COVERS  
15,000 SQ. FT.

FACE PANEL

# ACE GREEN TURF®

## Weed and Feed

**KILLS LISTED WEEDS WHILE FEEDING YOUR LAWN**

Para Desherbar y Alimentar

30-0-4

Net Wt. 42 lbs.  
(19.1 kg)



Kills over  
**250**  
Weeds  
as listed

Kills clover,  
chickweed, spurge  
and many other listed  
broadleaf weeds

Promotes root  
growth for a thicker,  
greener lawn

|                           |         |
|---------------------------|---------|
| ACTIVE INGREDIENTS:       |         |
| 2,4-D, 2-ethylhexyl ester | 1.108%  |
| Metoprop-p acid           | 0.167%  |
| Dicamba acid              | 0.071%  |
| OTHER INGREDIENTS:        | 98.654% |
| TOTAL                     | 100.00% |

**THIS PRODUCT CONTAINS:**

14.70 lb. 2,4-dichlorophenoxyacetic acid equivalent per ton or 0.735%, CAS 1928-43-4.  
3.34 lb. (+)-[R]-2-(2-methyl-4-chlorophenoxy) propionic acid equivalent per ton or 0.167%, CAS 16484-77-8.  
1.42 lb. 3,6-dichloro-o-anisic acid equivalent per ton or 0.071%, CAS 1918-00-9

Isomer Specific by AOAC Methods

TRIMECO® is a registered trademark of PBI/Gordon Corporation.

**KEEP OUT OF REACH OF CHILDREN**  
**CAUTION**

See back panel for First Aid and additional Precautionary Statements.

**Net Wt. 42 lbs. (19.1 kg)**



FACE PANEL

# ACE GREEN TURF®

## Weed and Feed

**KILLS LISTED WEEDS WHILE FEEDING YOUR LAWN**

*Para Desherbar y Alimentar*

**30-0-4**

**Net Wt. 42 lbs.  
(19.1 kg)**



**Kills over  
250  
Weeds  
as listed**

**Kills clover,  
chickweed, spurge  
and many other listed  
broadleaf weeds**

**Promotes root  
growth for a thicker,  
greener lawn**

**ACTIVE INGREDIENTS:**

|                                 |         |
|---------------------------------|---------|
| 2,4-D, 2-ethylhexyl ester ..... | 1.108%  |
| Mecoprop-p acid .....           | 0.167%  |
| Dicamba acid. ....              | 0.071%  |
| OTHER INGREDIENTS: .....        | 98.654% |
| TOTAL .....                     | 100.00% |

**THIS PRODUCT CONTAINS:**

14.70 lb. 2,4-dichlorophenoxyacetic acid equivalent per ton or 0.735%. CAS 1928-43-4.  
3.34 lb. (+)-(R)-2-(2-methyl-4-chlorophenoxy) propionic acid equivalent per ton or 0.167%. CAS 16484-77-8.  
1.42 lb. 3,6-dichloro-o-anisic acid equivalent per ton or 0.071%. CAS 1918-00-9

Isomer Specific by AOAC Methods

TRIMEC® is a registered trademark of PBI/Gordon Corporation.

**KEEP OUT OF REACH OF CHILDREN  
CAUTION**

See back panel for First Aid and additional Precautionary Statements.

**Net Wt. 42 lbs. (19.1 kg)**



# ACE GREEN TURF<sup>®</sup> Weed and Feed

**KILLS LISTED WEEDS WHILE FEEDING YOUR LAWN**

**30-0-4**

*Para Desherbar y Alimentar*

Net Wt. 42 lbs.  
(19.1 kg)



**READ THE ENTIRE LABEL FIRST.  
OBSERVE ALL PRECAUTIONS AND  
FOLLOW DIRECTIONS CAREFULLY.**

## PRECAUTIONARY STATEMENTS

### **Hazards to Humans and Domestic Animals**

**CAUTION.** Causes moderate eye irritation. Avoid contact with eyes or clothing. Wash thoroughly with soap and water after handling and before eating, drinking, chewing gum, using tobacco or using the toilet.

## FIRST AID

### **IF IN EYES:**

- Hold eye open and rinse slowly and gently with water for 15-20 minutes. Remove contact lenses, if present, after the first 5 minutes, then continue rinsing eye.
- Call poison control center or doctor for treatment advice.

Have the product container or label with you when calling a poison control center or doctor or going for treatment. For Emergency Medical Treatment Information call: 1-888-208-1368.

## ENVIRONMENTAL HAZARDS

This pesticide is toxic to fish and aquatic invertebrates and may adversely affect non-target plants. To protect the environment, do not allow pesticide to enter or run off into storm drains, drainage ditches, gutters or surface waters. Applying this product in calm weather when rain is not predicted for next 24 hours will help to ensure that wind or rain does not blow or wash pesticide off the treatment area. Sweeping any product that lands on a driveway, sidewalk, or street back onto the treated area of the lawn will help to prevent run off to water bodies or drainage systems.

This chemical has properties and characteristics associated with chemicals detected in groundwater. The use of this chemical in areas where soils are permeable, particularly where the water table is shallow, may result in groundwater contamination. Application around a cistern or well may result in contamination of drinking water or groundwater.

## DIRECTIONS FOR USE

It is a violation of Federal law to use this product in a manner inconsistent with its labeling.

- Do not apply this product in a way that will contact any person or pet either directly or through drift.
- This product is for residential use.
- Do not allow people (other than applicator) or pets on treatment area during treatment. Do not enter treatment area until dust has settled.

Ace Green Turf Weed and Feed contains Trimec<sup>®</sup> Herbicide. Trimec<sup>®</sup> controls a wide range of lawn weeds, including dandelion, chickweed, plantain, henbit, spurge and many other listed weeds commonly found in home lawns. In addition, a 30-0-4 fertilizer provides a supply of lawn food. Possible retreatment may be necessary if (a) the lawn is heavily overrun by weeds or, (b) if adverse low moisture conditions prevail and weeds are in a state of poor growth. A second application may be made after 30 days. Treated areas may be seeded 3 weeks after application.

## USE PRECAUTIONS

- Do not use on dichondra, carpetgrass, 'Floritam' St. Augustinegrass, creeping bentgrass, or turfgrass where desirable clovers are present.
- Do not apply this product on newly seeded grasses until well-established or after the second or third mowing.
- Do not use this product on flowers, vegetables, groundcovers, gardens or landscape plantings including shrubs and trees. Do not exceed specified dosage for any area and do not apply this product within the dripline of or over surface roots of trees, shrubs, and other ornamentals.
- Reseeding or overseeding areas may occur three (3) weeks after the application of this product.
- Do not use this product on or near desirable plants and avoid spreading granules onto exposed root systems or adventitious shoots (rhizomes) within the drip line of the roots of desirable trees and shrubs, since injury may result.
- Do not apply directly to or near water, storm drains, gutters, sewers, or drainage ditches. Do not apply within 25 feet of rivers, fish ponds, lakes, streams, reservoirs, marshes, estuaries, bays, and oceans. Do not apply when windy. Apply this product directly to your lawn, and sweep any product landing on the driveway, sidewalk, gutter, or street back onto the treated area. To prevent product run-off, do not over water the treated area(s) to the point of runoff or apply when raining or when rain is expected that day.

## HOW MUCH TO APPLY

**For use on Kentucky bluegrass, fescue spp., perennial ryegrass, common bermudagrass, bahiagrass, zoysiagrass, St. Augustinegrass, centipedegrass, hybrid bermudagrass, and colonial bentgrass:** Apply 2.8 pounds of product per 1,000 square feet of turfgrass. A second application may be made after 30 days. The maximum number of broadcast applications per treatment site is 2 per year.

### Maximum use rate statement:

Do not apply more than 2.8 pounds of product per 1000 square feet of turfgrass per application. If necessary, a second application may be made no sooner than 30 days after the first. Do not apply more than 5.6 pounds of product per 1000 square feet per year.

## WHEN TO APPLY

Apply when broadleaf weeds are actively growing in spring or early fall.

Apply when the air is calm to ensure uniform coverage and avoid spreading granules onto flowers, vegetables, and ornamental shrubbery.

## APPLICATION INSTRUCTIONS

1. Mow lawn to normal height 1 to 2 days before application.
2. Water lawn thoroughly at least 1 to 2 days before application to sustain moisture until the next watering (see step 5).
3. Apply when weeds are young and actively growing, preferably in the morning when the dew is on the grass. If grass is not moist at time of application, sprinkle lightly with water before applying product.
4. Avoid applying when temperatures are consistently above 90° F.
5. Do not wash from weed leaves for 1 to 2 days after application. At this time, a thorough watering should be made.

### GUARANTEED ANALYSIS 30-0-4

|   |       |
|---|-------|
| Total Nitrogen (N) .....                | 30.0% |
| 3.6% Ammoniacal Nitrogen                |       |
| 2.2% Water Insoluble Nitrogen*          |       |
| 20.4% Urea Nitrogen                     |       |
| 3.8% Other Water Soluble Nitrogen*      |       |
| Soluble Potash (K <sub>2</sub> O) ..... | 4.0%  |
| Sulfur (S) .....                        | 4.0%  |
| 4.0% Combined Sulfur (S)                |       |

Derived from: Ammonium sulfate, Methylene Ureas, Urea, Muriate of Potash.

Chlorine (Cl) ..... 4.0%

\* 6.0% Slowly Available Nitrogen from Methylene Ureas.



## ACE GREEN TURF WEED & FEED CONTROLS MORE THAN 250 WEEDS!

|                          |                          |                        |                            |                            |                            |
|--------------------------|--------------------------|------------------------|----------------------------|----------------------------|----------------------------|
| Amaranth, purple         | Chickweed, mouseear      | Fleabane, rough        | Mustard, blue              | Pusley, florida            | Thistle, scotch            |
| Amaranth, slender        | Chickweed, sticky        | Galinsoga, hairy       | Mustard, hedge             | Pusley, large flower       | Thistle, wavyleaf          |
| Aster, heath             | Chicory                  | Galinsoga, smallflower | Mustard, indian,           | Ragweed, bur               | Thistle, yellow (horrible) |
| Aster, white heath       | Cinquefoil               | Goldenrod              | Mustard, tansy             | Ragweed, common            | Trailing crownvetch        |
| Aster, purple            | Clover, crimson          | Ground ivy             | Mustard, tumble            | Ragweed, lancleaf          | Velvetleaf                 |
| Aster, white prairie     | Clover, alyce            | Groundsel              | Mustard, white             | Ragweed, western           | Vervain, blue              |
| Artichoke                | Clover, hop              | Gumweed                | Mustard, wormseed          | Redstem filaree            | Vervain, hoary             |
| Austrian fieldcress      | Clover, rabbit foot      | Hairy fleabane         | Nettle, stinging (burning) | Rough cinquefoil           | Vervain, prostrate         |
| Bedstraw, Catchweed      | Clover, red              | Hawkweed, meadow       | Nettle, tall               | Scarlet pimpernel          | Vervain, tall              |
| Bedstraw, smooth         | Clover, strawberry       | Hawkweed, mouseear     | Nettle, wood               | Shepardspurse              | Vetch, bird                |
| Bedstraw, Northern       | Clover, yellow sweet     | Hawkweed, orange       | Parsley-piert              | Smartweed, ladysthumb      | Vetch, hairy               |
| Bedstraw, pineywoods     | Clover, white sweet      | Hawkweed, yellow       | Parsnip                    | Smartweed, pale            | Vetch, milk                |
| Beggarticks, hairy       | Clover, white            | Healall                | Pearlwort                  | Smartweed, pennsylvania    | Vetch, narrowleaf          |
| Betony, Florida          | Cockle                   | Heartleaf drymary      | Pennycress (frenchweed)    | Smooth chaff-flower        | Vetch, wild                |
| Bindweed, Field          | Cocklebur                | Hemp                   | Pepperweed, perennial      | Smoothdock                 | Virginia creeper           |
| Bindweed, Hedge          | Cocklebur, oriental      | Henbit                 | Pepperweed, virginia       | Sorrel, red (sheep)        | Western clematis           |
| Bitter Wintercress       | Cocklebur, spiny         | Hoary cress            | (Peppergrass)              | Sowthistle, annual         | Western salsify            |
| Bittercress, hairy       | Common mullein           | Horsenettle            | Pigweed, prostate          | Sowthistle, spiny          | Wild aster                 |
| Bitterweed               | Corn Spurry              | Horseweed              | Pigweed, redroot           | Spanish needles            | Wild buckweed              |
| Black-eyed Susan         | Creeping Beggarweed      | Jimsonweed             | Pigweed, russian           | Speedwell, bi-lobed        | Wild carrot                |
| Black Medic              | Creeping Jenny           | Johnny-Jumpup violet   | Pigweed, smooth            | Speedwell, common          | Wild four-o'clock          |
| Blood flower milkweed    | (creeping charlie)       | Knawel                 | Pigweed, tumble            | Speedwell, corn            | Wild garlic                |
| Blue lettuce             | Cupid shaving Brush      | Knotweed, prostrate    | Pineapple weed             | Speedwell, ivyleaf         | Wild lettuce               |
| Brassbuttons             | Cudweed                  | Kochia                 | Plains coreopsis           | Speedwell, persian         | Wild marigold              |
| Bristly oxtongue         | Daisy, English           | Lambsquarters          | (tickseed)                 | Speedwell, purslane        | Wild mustard (yellow       |
| Broomweed                | Daisy, oxeye             | Lespedeza              | Plantain, blackseed        | Speedwell, slender         | rocket)                    |
| Buckhorn                 | Dandelion, common        | Mallow, alkali         | Plantain, bracted          | Speedwell, snow            | Wild onion                 |
| Bullnettle               | Dandelion, false         | Mallow, bristly        | Plantain, broadleaf        | Speedwell, thymeleaf       | Wild parsnip               |
| Burclover                | Day flower               | Mallow, common         | Plantain, buckhorn         | Spiny amaranth             | Wild radish                |
| Burdock                  | Deadnettle               | Mallow, dwarf          | Plantain, hoary            | Spurge, spotted            | Wild rape                  |
| Burweed, lawn            | Dichondra                | Mallow, venice         | Plantain, narrowleaf       | Spurge, prostrate          | Wild strawberry            |
| (spurweed)               | Dock, broadleaf          | Marcela                | Plantain, slender          | Spurweed                   | Wild sweet potato          |
| Buttercup, bulbous       | Dock, curly              | Matchweed              | Plantain, woolly           | Star of Bethlehem          | Wild violet                |
| Buttercup, creeping      | Dogbane                  | Mexicanweed            | Poison ivy                 | Strawberry, India mock     | Woodsorrel, creeping       |
| Buttonweed, common       | Dogfennel                | Moneywort              | Poison oak                 | Tansy ragwort              | Woodsorrel, violet         |
| (poorjoe)                | Dollarweed (Pennywort)   | Morningglory, bigroot  | Pokeweed                   | Tanweed                    | Woodsorrel, yellow         |
| Buttonweed, virginia     | Dove weed                | Morningglory, ivyleaf  | Prairie Sunflower          | Thistle, blessed           | (Oxalis)                   |
| Carolina geranium (wild) | Elderberry               | Morningglory, mexican  | Prickly lettuce            | Thistle, bull              | Woolly croton              |
| Carpetweed               | Falseflax                | Morningglory, red      | (compass plant)            | Thistle, canada            | Wormseed                   |
| Catnip                   | False sunflower          | Morningglory, tall     | Prickly sida               | Thistle, flodman (prairie) | Yarrow, common             |
| Catsear, spotted (false  | Fiddleneck               | Morningglory, wolly    | Prostrate knotweed         | Thistle, musk              | Yarrow, western            |
| dandelion)               | Filaree, redstem         | Mugwort                | Puncturevine               | Thistle, platte            | Yarrow, yellow             |
| Chamber bitter           | Filaree, whitestem       | Mustard, ball          | Purslane, common           | Thistle, plumeless         |                            |
| Chickweed, common        | Fleabane, daisy (annual) | Mustard, black         | Pusley, brazil             | Thistle, russian           |                            |

## SPREADER DIRECTIONS

**Determining Your Lawn's Square Footage:** To determine how much of this product to apply, you must determine the square footage of your lawn. An easy way to do this is to walk the length of your lawn, figuring that one pace equals about 3 feet. Do the same with the width of the lawn. Then multiply the length by the width to arrive at the total. Make sure you subtract the square footage of your home and driveway when calculating the total square footage of your lawn. If your lawn has an irregular shape, try dividing it up into a number of square areas. Calculate the square footage for each area, then add the figures together to reach your total lawn size.

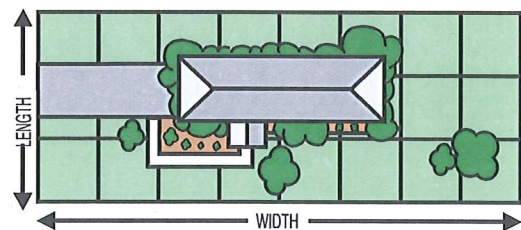

**Spreader Tips:** The two main types of spreaders are the Drop Spreader, which drops the material straight down the width of the spreader as you push, and the Broadcast Spreader (also known as a rotary), which throws the material from the spreader.

Fig. A

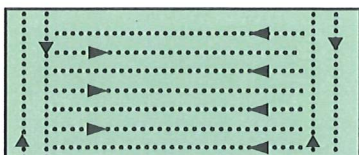

**Drop Spreader:** (See Fig. A) First make two passes along the top of the area you'll be covering. Then make two passes along the bottom area. Then move back and forth along the long part of the lawn. On each pass, as you reach the strips at the top and bottom of the area to be covered, shut off the spreader. It's also important to shut off the spreader when you are stopped.

Fig. B

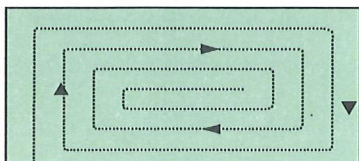

**Broadcast Spreader:** (See Fig. B) Apply in a single pass by starting on the outside border and apply in a circular path working toward the center.



## SPREADER SETTINGS (DELIVERS 2.8 LBS./1,000 SQ. FT.)

| MODEL                          | SETTING |
|--------------------------------|---------|
| Ace 2030AT Rotary              | 14      |
| Earthway 2000A, 2050P Rotary   | 14      |
| Scotts Accugreen 1000 Drop     | 7       |
| Scotts Accugreen 2000 Drop     | 7       |
| Scotts Accugreen 3000 Drop     | 7       |
| Scotts SpeedyGreen 1000 Rotary | 4 1/2   |
| Scotts SpeedyGreen 2000 Rotary | 4 1/2   |
| Scotts SpeedyGreen 3000 Rotary | 4 1/2   |

## STORAGE AND DISPOSAL

Do not contaminate water, food or feed by storage and disposal. **PESTICIDE STORAGE:** Store product in its original container in a cool, dry, locked place out of the reach of children and animals.

**PESTICIDE DISPOSAL AND CONTAINER HANDLING:** Nonrefillable container. Do not reuse or refill this container. **If empty:** Place in trash or offer for recycling if available. **If partially filled:** Call your local solid waste agency for disposal instructions. Never place unused product down any indoor or outdoor drain.



## QUESTIONS OR COMMENTS?

Call 1-800-233-1067

### WARRANTY IMPORTANT: READ BEFORE USE

Read the entire Directions for Use, Conditions, Disclaimer of Warranties and Limitations of Liability before using this product. If terms are not acceptable, return the unopened product container at once.

By using this product, user or buyer accepts the following Conditions, Disclaimer of Warranties and Limitations of Liability.

**CONDITIONS:** The directions for use of this product are believed to be adequate and must be followed carefully. However, it is impossible to eliminate all risks associated with the use of this product. Crop injury, ineffectiveness or other unintended consequences may result because of such factors as weather conditions, presence of other materials, or the manner of use or application, all of which are beyond the control of Lebanon Seaboard Corporation. All such risks shall be assumed by the user or buyer.

**DISCLAIMER OF WARRANTIES:** To the extent consistent with applicable law, LEBANON SEABOARD CORPORATION MAKES NO OTHER WARRANTIES, EXPRESS OR IMPLIED, OF MERCHANTABILITY OR OF FITNESS FOR A PARTICULAR PURPOSE OR OTHERWISE, THAT EXTEND BEYOND THE STATEMENTS MADE ON THIS LABEL. No agent of Lebanon Seaboard Corporation is authorized to make any warranties beyond those contained herein or to modify the warranties contained herein. To the extent consistent with applicable law, Lebanon Seaboard Corporation DISCLAIMS ANY LIABILITY WHATSOEVER FOR SPECIAL, INCIDENTAL OR CONSEQUENTIAL DAMAGES RESULTING FROM THE USE OR HANDLING OF THIS PRODUCT.

**LIMITATIONS OF LIABILITY:** To the extent consistent with applicable law, THE EXCLUSIVE REMEDY OF THE USER OR BUYER FOR ANY AND ALL LOSSES, INJURIES OR DAMAGES RESULTING FROM THE USE OR HANDLING OF THIS PRODUCT, WHETHER IN CONTRACT, WARRANTY, TORT, NEGLIGENCE, STRICT LIABILITY OR OTHERWISE, SHALL NOT EXCEED THE PURCHASE PRICE PAID, OR AT LEBANON SEABOARD CORPORATION'S ELECTION, THE REPLACEMENT OF PRODUCT.

Information regarding the contents and levels of metals in this product is available on the internet at <http://www.regulatory-info-lebsea.com>

Manufactured by:  
Lebanon Seaboard Corporation  
1600 East Cumberland Street  
Lebanon, PA 17042

EPA Reg. No. 961-415

EPA Est. No. 961-PA-01 (L), 961-IL-01 (D), 59144-GA-1 (BE)

Circled letter(s) is first letter(s) of lot number.

Made in the USA for Ace Hardware Corp.,  
Oak Brook, Illinois, 60523, USA ©2011  
[www.acehardware.com](http://www.acehardware.com)

Green Turf® is a registered trademark of United Industries Corporation.



### The Ace® Promise

*If this Ace product when used for its intended purpose, fails to give you complete satisfaction, return the item to the Ace Hardware store where purchased for free replacement of the same or similar item.*

### El Compromiso de Ace®

*Si este producto Ace, cuando se usa para los fines entendidos, no funciona a su entera satisfacción, devuélvalo a la ferretería de Ace Hardware donde lo compró para que se lo reemplacen sin costo por uno igual o similar.*

NOT PROOF OF PURCHASE

