



Home Pest Roach Killer Gel



Home Pest Roach Killer Gel

- **Up to 6 Months* Protection**
- **Contains 75+ Placements**
Enough Bait to Treat an Average Home



- Hasta 6 meses de protección
- Contiene más de 75 colocaciones
(suficiente cebo como para tratar un hogar promedio)



Scan for
how to use

Home Pest
Roach Killer Gel

KEEP OUT OF REACH OF CHILDREN
CAUTION See back for additional precautionary statements and First Aid

Active Ingredient: Imidacloprid 2.15%
Other Ingredients 97.85%
Total 100.00% *or until bait is consumed

NET CONTENTS 0.53 OZ (15 G)

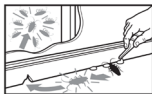

READ THE LABEL FIRST!



QUICK FACTS

- Very attractive to roaches so they die fast!
- Kills roaches in cracks, crevices, cabinets, and wall voids
- Easy to apply – no odor / no mess

KILLS	Cockroaches, including German, American, Smokybrown, Oriental and other species
WHERE TO USE	Areas cockroaches seek food, water, or shelter. Areas cockroaches travel. For example, Kitchens, Bathrooms, Laundry rooms, Basements, Garages, and Outdoor areas.
WHEN TO USE	When cockroaches are present
	For questions or comments, call toll-free 1-877-BayerAG (1-877-229-3724), or visit us on-line at www.BayerAdvanced.com

DIRECTIONS FOR USE

It is a violation of Federal law to use this product in a manner inconsistent with its labeling. Read and follow all label directions.

BEFORE YOU USE

- Apply only to areas not easily accessible to children and pets.
- Avoid applying gel to fabric or carpeting, as it may stain some materials.
- Do not apply in or on electrical equipment due to the possibility of shock.
- Gel cleans up easily with damp paper towel while still wet.

WHERE TO USE

- Kitchens - Cupboards, Dishwashers*, Garbage Cans, Refrigerators*, Stoves*
- Bathrooms - Bathtubs*, Garbage Cans • Laundry Rooms - Drains, Laundry Tubs*, Washing Machines*
- Basements, Garages, Outdoor Areas - Drains, Garbage Cans, Laundry Tubs*, Manholes, Pipe Collars, Sewers, Washing Machines*, Water Pipes*
- General - Cabinets, Closets, Counters, Cracks, Crevices, Shelving, Sinks

* Do not apply bait inside these items. Locate behind or under item.

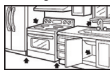

HOW MUCH TO APPLY

- Spot Treatment: 1 – 2 spots per square yard, each spot ¼" across.
- Crack and Crevice Treatment: Squeeze a small amount into crack or crevice.

• Recommended spot size



HOW TO APPLY

- 1) Remove cap from tip. 2) Place tip against area to be treated. 3) To dispense, press button to deliver on bait placement. *NOTE: The first time will require several pumps to prime prior to dispensing.*
- 4) When finished, replace cap.

DIRECTIONS FOR USE (cont'd) FOR BEST RESULTS

- Numerous, smaller bait placements will provide faster more effective control than fewer larger placements.
- Gel must be applied to clean, dry surfaces.
- If bait is completely eaten, reapply more to the same site since additional roaches will be attracted by the secretions and droppings left by the earlier cockroaches.
- Do not apply roach baits to areas recently sprayed with insecticides and do not spray insecticides over these baits. The spray insecticides may repel roaches from the baited area.

HOW THIS PRODUCT WORKS

This bait was specifically formulated to be both a food and water source with extra long attractiveness. It contains a low level of insecticide which cockroaches cannot detect.

STORAGE AND DISPOSAL

Do not contaminate water, food, or feed by storage or disposal.

PESTICIDE STORAGE

Store in original container in a cool, dry place, out of the reach of children, preferably a locked storage cabinet.

PESTICIDE DISPOSAL AND CONTAINER HANDLING

 **If Empty:** Non-refillable container. Do not refill or reuse this container. Place in trash or offer for recycling if available.

If Partly Filled: Call your local solid waste agency or call 1-877-229-3724 for disposal instructions. Never place unused product down any indoor or outdoor drain.

PRECAUTIONARY STATEMENTS

CAUTION Hazards to Humans and Domestic Animals

- Causes moderate eye irritation.
- Avoid contact with eyes, skin, or clothing.
- Wash thoroughly with soap and water after handling and before eating, drinking, or using tobacco.

FIRST AID + neonicotynyl insecticide

IF IN EYES

- Hold eye open and rinse slowly and gently with water for 15 to 20 minutes.
- Remove contact lenses, if present, after the first 5 minutes, then continue rinsing eye.
- Call a poison control center or doctor for treatment advice.

IF SWALLOWED

- Call a poison control center or doctor immediately for treatment advice
- Have person sip a glass of water if able to swallow.
- Do not induce vomiting unless told to do so by the poison control center or doctor.
- Do not give anything by mouth to an unconscious person.

NOTE: Have the product container or label with you when calling a poison control center or doctor, or going for treatment. You may contact 877-229-3763 for emergency medical treatment information. Active Ingredient: 2.15% Imidacloprid [CAS # 138261-41-3]

NOTICE: Research and testing have determined that the "Directions for Use" are appropriate for the proper use of this product under expected conditions. To the extent consistent with applicable law, the Bayer assumes responsibility for lack of performance or safety if not used according to the directions.

US00000000a 140722AV1

Money Back Guarantee: If you are not satisfied with this product, we will gladly refund your original purchase price.

Produced for:

Bayer Advanced, A Division of Bayer CropScience LP, P.O. Box 12014, 2 T.W. Alexander Drive, Research Triangle Park, NC 27709

Bayer Advanced™, Bayer (reg'd), and Bayer Cross (reg'd) are trademarks of Bayer.

EPA Reg. No. 72155-70

EPA Est. No. indicated by 3rd and 4th digits of the batch number on this package.

(98) = 33967-NJ-1 (49) = 072155-AL-001



6

6

DOWN

UNPRINTABLE AREA (3mm)

KEEP OUT OF REACH OF CHILDREN
CAUTION See card for additional direction
for use

Active Ingredients:
Imidacloprid† 2.15%
Other Ingredients ... 97.85%
Total 100.00%

†CAS No. 138261-41-3

NET CONTENTS: .53 OZ (15 G)

Home Pest Roach Killer Gel



FIRST AID + neonicotynyl insecticide

IF IN EYES

- Hold eye open and rinse slowly and gently with water for 15 to 20 minutes.
- Remove contact lenses, if present, after the first 5 minutes, then continue rinsing eye.
- Call a poison control center or doctor for treatment advice.

IF SWALLOWED

- Call a poison control center or doctor immediately for treatment advice.
- Have person sip a glass of water if able to swallow.
- Do not induce vomiting unless told to do so by the poison control center or doctor.
- Do not give anything by mouth to an unconscious person.

NOTE: Have the product container or label with you when calling a poison control center or doctor, or going for treatment. You may contact 877-229-3763 for emergency medical treatment information. Active ingredient: 2.15% Imidacloprid [CAS # 138261-41-3]

Apply only to areas not easily accessible to children and pets.

PRECAUTIONARY STATEMENTS
CAUTION Hazards to Humans and Domestic Animals

- Causes moderate eye irritation.
- Avoid contact with eyes, skin, or clothing.
- Wash thoroughly with soap and water after handling and before eating, drinking, or using tobacco.

EPA Reg No. 72155-70
EPA Est. No indicated by 3rd and 4th digits of the batch number on this package
(98) = 33967-NJ-1 (49) = 072155-AL-001
Produced for: Bayer Advanced, A Division of Bayer CropScience LP, P.O. Box 12014,
21st W. Alexander Drive, Research Triangle Park, NC 27709 US00000000 140722AV1

FRONT PANEL

UNPRINTABLE AREA (3mm)