

**Easy
to Use!**

**Calibrated,
No Settings!**

Ready2Go
SPREADER

GREENVIEW®

CRABGRASS CONTROL

PLUS LAWN
FOOD WITH **Preen**

- Helps lawns retain water to **protect against heat & drought**
- Feeds your lawn **up to 8 weeks**
- Apply in **spring**

**PREVENTS CRABGRASS
ALL SEASON**

**KEEP OUT OF REACH
OF CHILDREN**

CAUTION

See container label for First Aid and additional Precautionary Statements

For control of crabgrass and control or suppression of many other listed annual grass and broadleaf weeds in established lawns and ornamental turf.

In the state of New York, do not exceed 3.0 lb. of this product per 1000 sq. ft. per year (equivalent to 0.25 pounds of active ingredient per acre).

NET WEIGHT 6.75 lbs. (3.06 kg)
Covers 2,500 sq. ft.

ACTIVE INGREDIENT:
Dithiopyr..... 0.19%

OTHER INGREDIENTS: 99.81%

TOTAL 100.00%

Ready2Go
SPREADER

GREENVIEW

CRABGRASS CONTROL

PLUS LAWN
FOOD WITH

Preen

NOTICE: Read the entire label. Use only according to label directions. Before buying this product, read the Warranty Section elsewhere on this label. If terms are not acceptable, return the unopened container at once.

**CARE & HANDLING
PRECAUTIONARY STATEMENTS
HAZARDS TO HUMANS AND DOMESTIC ANIMALS
CAUTION**

Causes moderate eye irritation. Avoid contact with eyes or clothing. Wash thoroughly with soap and water after handling and before eating, drinking, chewing gum, or using tobacco.

FIRST AID

- If in eyes:
 - Hold eye open and rinse slowly and gently with water for 15 - 20 minutes.
 - Remove contact lenses, if present, after the first 5 minutes, then continue rinsing eye.
 - Call a poison control center or doctor for treatment advice.
- If inhaled:
 - Move person to fresh air.
 - If person is not breathing, call 911 or an ambulance, then give artificial respiration, preferably mouth-to-mouth if possible.
 - Call a poison control center or doctor for further treatment advice.

Have the product container or label with you when calling a poison control center or doctor, or going for treatment. For Emergency Medical Treatment Information call (888)208-1368.

ENVIRONMENTAL HAZARDS

This product is toxic to fish and highly toxic to other aquatic organisms including oysters and shrimp. Use with care when applying to turf areas adjacent to any body of water. Drift and runoff from treated turf may adversely affect aquatic organisms in adjacent aquatic sites. Do not apply when weather conditions favor drift from treated areas. To protect the environment, do not allow pesticide to enter or run off into storm drains, drainage ditches, gutters or surface waters. Applying this product in calm weather will help to ensure that wind does not blow pesticide off the treatment area. Sweeping any product that lands on a driveway, sidewalk, or street, back onto the treated area of the lawn will help to prevent run off to water bodies and drainage systems.

GUARANTEED ANALYSIS 26-0-4

Total Nitrogen (N)	26%
3.2% Ammoniacal Nitrogen	
2.0% Water Insoluble Nitrogen*	
17.5% Urea Nitrogen	
3.3% Other Water Soluble Nitrogen*	
Soluble Potash (K ₂ O)	4%
Sulfur (S)	3.6%
3.6% Combined Sulfur (S)	
Derived From: Ammonium Sulfate, Methylene Ureas, Urea, Muriate of Potash.	
Chlorine (Cl) not more than	4%
*5.3% Slowly Available Nitrogen from Methylene Ureas.	
F699	

Information regarding the contents and levels of metals in this product is available on the internet at: <http://www.regulatory-info-lebsea.com>

MANUFACTURED BY:

Lebanon Seaboard Corporation
1600 East Cumberland Street, Lebanon, PA 17042
Made in the U.S.A. of U.S. and imported parts
www.greenviewfertilizer.com

EPA Reg. No. 961-417

(L) (D)

EPA Est. No. 961-PA-01, 961-IL-01

Superscript used is first letter of lot number.

GreenView® is a registered trademark of Lebanon Seaboard Corporation.
Preen® is a registered trademark of Lebanon Seaboard Corporation.
Ready2Go SPREADER and design is a trademark of Lebanon Seaboard Corporation.



SEE INSIDE BOOKLET FOR COMPLETE DIRECTIONS FOR USE.

LIFT HERE TO OPEN PRESS TO RESEAL

21-29770

Ready2Go SPREADER™

**BATTERY POWERED
WITH REFILLABLE
CONTAINER**

NOTICE: Read the entire label. Use only according to label directions. Before buying this product, read the Warranty Section elsewhere on this label. If terms are not acceptable, return the unopened container at once.

**CARE & HANDLING
PRECAUTIONARY STATEMENTS
HAZARDS TO HUMANS AND DOMESTIC ANIMALS
CAUTION**

Causes moderate eye irritation. Avoid contact with eyes or clothing. Wash thoroughly with soap and water after handling and before eating, drinking, chewing gum, or using tobacco.

DIRECTIONS FOR USE

It is a violation of Federal law to use this product in a manner inconsistent with its labeling.
Read all Directions for Use carefully before applying.

REFILL INSTRUCTIONS

- This container with Ready2Go Spreader™ is reusable with this product.
- Refill the container with desired amount of this product and use as directed.
- When done, store or dispose of this container as listed on the label.

STORAGE AND DISPOSAL

Do not contaminate water, food or feed by storage and disposal.

Pesticide Storage: Store product in its original container in a cool, dry, locked place out of the reach of children and animals.

Pesticide Disposal and Container Handling: Nonrefillable container. Do not reuse or refill this container except as described in the DIRECTIONS FOR USE (see Refill Instructions).

If Empty: Place in trash or offer for recycling if available.

If partly filled: Call your local solid waste agency for disposal instructions. Never place unused product down any indoor or outdoor drain.

GUARANTEED ANALYSIS 26-0-4

Total Nitrogen (N)	26%
3.2% Ammoniacal Nitrogen	
2.0% Water Insoluble Nitrogen*	
17.5% Urea Nitrogen	
3.3% Other Water Soluble Nitrogen*	
Soluble Potash (K₂O)	4%
Sulfur (S)	3.6%
3.6% Combined Sulfur (S)	
Derived From: Ammonium Sulfate, Methylene Ureas, Urea, Muriate of Potash.	
Chlorine (Cl) not more than	4%
* 5.3% Slowly Available Nitrogen from Methylene Ureas.	
	F699

Information regarding the contents and levels of metals in this product is available on the internet at:
<http://www.regulatory-info-lebsea.com>

EPA Reg. No. 961-417

(L) (D)

EPA Est. No. 961-PA-01, 961-IL-01

Superscript used is first letter of lot number.

21-29770

MANUFACTURED BY:

Lebanon Seaboard Corporation
1600 East Cumberland Street, Lebanon, PA 17042
Made in the U.S.A. of U.S. and imported parts
www.greenviewfertilizer.com



GREENVIEW CRABGRASS CONTROL PLUS LAWN FOOD WITH PREEN

**KEEP OUT OF REACH OF CHILDREN
CAUTION**

See Container label for First Aid and additional Precautionary Statements

ACTIVE INGREDIENT:

Dithiopyr 0.19%

OTHER INGREDIENTS: 98.81%

TOTAL 00.00%

HOW THIS PRODUCT WORKS

Not for use on turf being grown for sale or other commercial use as sod, or for commercial seed production, or for research purposes.

GreenView Crabgrass Control plus Lawn Food with Preen can be applied up to 4 weeks later than other crabgrass preventers and provides up to 4 months of crabgrass control.

GreenView Crabgrass Control plus Lawn Food with Preen provides preemergence control of crabgrass and control or suppression of other listed weeds when applied prior to their germination. In addition, this product provides postemergence control of seedling crabgrass after germination and emergence. Postemergence control is limited to crabgrass only, but is effective up to 4 weeks after crabgrass has germinated. This generally corresponds to the time when crabgrass seedlings first become visible in the established turfgrass. Do not apply this product later than 4 weeks after crabgrass germination.

Apply this product only to turfgrass species listed on this label. The following turfgrass species are tolerant to this product when applied as directed:

Cool-Season Grasses: Bentgrass, creeping; Bluegrass, Kentucky; Fescue, fine; Fescue, tall; Ryegrass, perennial

Warm-Season Grasses: Bahiagrass; Bermudagrass; Buffalograss; Carpetgrass; Centipedegrass; St. Augustinegrass; Zoysiagrass

USE PRECAUTIONS

GreenView Crabgrass Control plus Lawn Food with Preen must be applied only to lawns and ornamental turfgrasses that are well established. For newly established lawns, use the initial application of this product only after turfgrasses have developed a vigorous root system, uniform stand, and received at least two mowings following seeding, sodding, or sprigging. Exception: In newly established lawns of Kentucky bluegrass, perennial ryegrass and/or tall fescue, this product may be applied two weeks after the first sign of germination.

- Use of this product on lawns and ornamental turfgrasses that are not well established, or weakened by stress due to mechanical operations, pests, excessive temperatures, or lack of moisture may result in turfgrass injury.

- For best results, cultural practices that disturb the soil, such as core-, spike-, or hydro-aerification, and verticutting, are to be done before application of this product. Do not apply this product until turfgrass has recovered from the mechanical injury caused by these cultural practices.

- Reseeding, Overseeding, or Sprigging: Reseeding, overseeding, or sprigging of areas treated with this product within 10 weeks after a single application of this product or within 16 weeks after a split application program totaling 6.0 lb./1000 sq. ft. (0.5 lb. active ingredient per acre) or more may inhibit the establishment of desirable turfgrasses. When reseeding, overseeding follow proper cultural practices for seedbed preparation, seeding, irrigation and fertilization.

- Do not use clippings from treated turf for mulching around vegetables or fruit trees.

- Do not allow people or pets to enter treated area until dust has settled.

Use protective eyewear when using battery powered spreader.

HOW TO APPLY

To optimize product performance apply this product within a few days after mowing and delay mowing again for a few days after the application. Most effective weed control will be obtained when GreenView Crabgrass Control plus Lawn Food with Preen is activated by rainfall or irrigation. Performance is improved if application is followed by 1/2 inch of rainfall or irrigation. Erratic weed control may result if not activated by rainfall or irrigation within 30 days after application.

HOW MUCH TO APPLY

GreenView Crabgrass Control plus Lawn Food with Preen will provide up to 4 months of crabgrass control when applied according to label directions. The actual length of control will vary depending on use rate, weather conditions, condition of the turfgrass, intensity of weed pressure, and the location or "Region" within the United States where this product is being applied.

Refer to the map below to determine the region of the U.S. that includes your location. Use the table below to determine the amount of GreenView Crabgrass Control plus Lawn Food with Preen to apply in your location based on the desired length of weed control or need for postemergence crabgrass control.

Use "Regions" within the United States:



Product Use Rates:

Region of U.S.	Amount of GreenView Crabgrass Control plus Lawn Food with Preen to Apply (Pounds of product to apply per 1,000 square feet of turfgrass ¹)		
	Length of Crabgrass Control		
	2-3 months	3-4 months	Early Postemergence Control
North	1.5 lb./1000 sq. ft. (0.128 lb. ai/acre)	2.1 lb./1000 sq. ft. (0.174 lb. ai/acre)	2.7 lb./1000 sq. ft. (0.22 lb. ai/acre)
South	2.3 lb./1000 sq. ft. (0.192 lb. ai/acre)	2.7 lb./1000 sq. ft. (0.22 lb. ai/acre)	2.7 lb./1000 sq. ft. (0.22 lb. ai/acre)

¹1,000 square feet equals an area 100 feet X 10 feet or square area of about 32 feet on a side.

MAXIMUM APPLICATION RATES

- Do not apply more than 6.0 lb. of this product per 1,000 sq. ft. per application and no more than 18.0 lb. of this product/1000 sq. ft. per year (equivalent to 0.5 and 1.5 lb. of active ingredient per acre, respectively).
- In the state of New York, do not exceed 3.0 lb. of this product per 1000 sq. ft. per year (equivalent to 0.25 pounds of active ingredient per acre).

WHEN TO APPLY

SPRING APPLICATION

Control of Crabgrass: GreenView Crabgrass Control plus Lawn Food with Preen provides preemergence control of crabgrass and control or suppression of other listed weeds when applied prior to their germination. In addition, this product provides postemergence control of seedling crabgrass after germination and emergence. Postemergence control is limited to crabgrass only and is effective up to 4 weeks after germination of crabgrass. This generally corresponds to the time when crabgrass seedlings are at the 3-leaf stage of growth and first become visible in the established turf. This product will not control crabgrass at later growth stages when crabgrass plants begin to tiller (spread). Properly timed applications will control existing crabgrass and prevent further emergence of crabgrass seedlings. Do not apply this product later than 4 weeks after crabgrass germination.

Control or Suppression of Other Grass and Broadleaf Weeds: For control or suppression of other grass and broadleaf weeds, this product must be applied as a preventative treatment prior to their germination and emergence. Only crabgrass will be controlled with applications made up to 4 weeks after weed germination.

FALL APPLICATION

This product can also be applied from late summer through early fall (late August through November). When applied in the fall, a sequential or second application of this product must be made the following spring to provide season-long control of crabgrass. If this product is applied in the fall, do not reseed, overseed or sprig turfgrasses within 12 weeks after application.

READY2GO SPREADER™ DIRECTIONS: FIRST TIME USE



PLACE the Ready2Go Spreader™ UPSIDE DOWN on a flat surface (the GREEN BASE facing up).

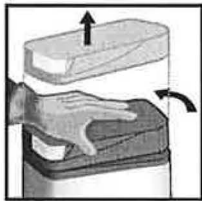

HOLD the container steady and TURN the base COUNTER-CLOCKWISE to left, approximately quarter turn, until it STOPS and LIFT to remove.

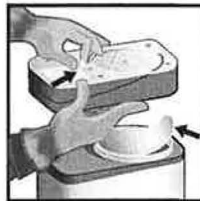

REMOVE the protective seal from the round opening, and PULL the tab from the battery compartment.

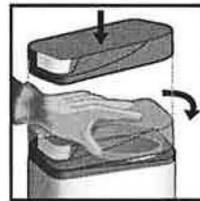

REALIGN the protruding tabs on the base with the slots on the container and TURN CLOCKWISE to right until the base LOCKS back in its original position.



FLIP the Ready2Go Spreader™ back to the UPRIGHT position. The Ready2Go Spreader™ is now ready to use.

TO REFILL YOUR READY2GO SPREADER™ CONTAINER

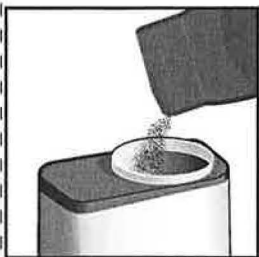

- PLACE the Ready2Go Spreader™ UPSIDE DOWN on a flat surface the GREEN BASE facing up.
- HOLD the container steady while TURNING the base COUNTER-CLOCKWISE until it STOPS and LIFT to remove.
- CUT a corner opening on the GreenView Crabgrass Control plus Lawn Food with Preen refill bag, and pour into the Ready2Go Spreader™ until the container is FULL.
- Replace the spreader unit base. Align tabs and slots and twist clockwise into place.
- FLIP the Ready2Go Spreader™ to the UPRIGHT position. The Ready2Go Spreader™ is now ready to operate. Follow application instructions.

DIRECTIONS FOR APPLYING THE PRODUCT TO YOUR LAWN

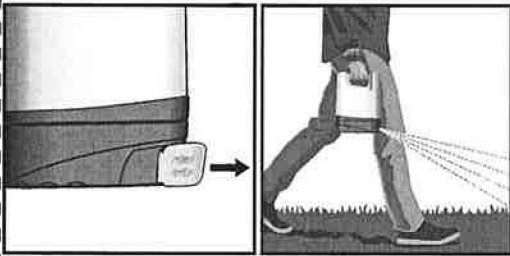

Move to the lawn area to be treated. POSITION the Ready2Go Spreader™ comfortably at your side (arm fully extended), over the target area, and TURN ON by pulling back the on/off slide switch.

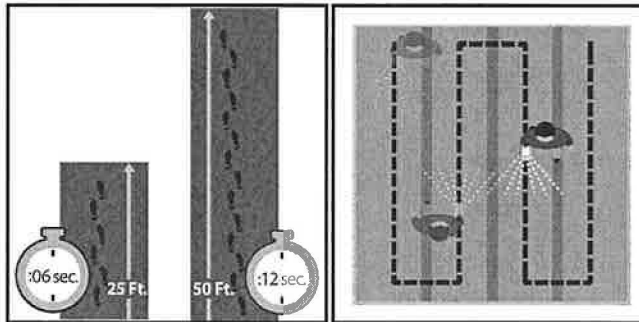

When product begins spreading, WALK over the application area at a NORMAL WALKING PACE. (6 seconds for a 25' strip, or 12 seconds for a 50' strip). CONTINUE to within 2' of the end of the application area, and begin a new row by taking 2 STEPS TO THE RIGHT OR LEFT, and walk back parallel to your first row. There should be a SLIGHT OVERLAP to the spread radius. CONTINUE in this manner until you have finished applying the product.

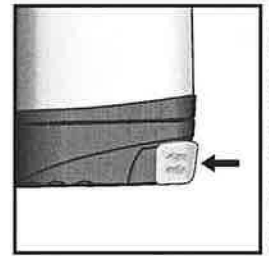

TURN OFF the Ready2Go Spreader™ by PUSHING IN the slide switch. If product remains, store in a cool, dry place. If empty and lawn application is finished, simply refill the container.

WEEDS CONTROLLED OR SUPPRESSED

GreenView Crabgrass Control plus Lawn Food with Preen will provide control of crabgrass and control or suppression of other listed grass and broadleaf weeds when applied prior their germination.

Grasses: barley; barnyardgrass; bluegrass, annual; brome; crabgrass, large; crabgrass, smooth; crabgrass, Southern; crowfootgrass[†]; dallisgrass; goosegrass; foxtail, green; foxtail, yellow; kikuyugrass[†]; oats, wild; ryegrass (annual & perennial); sandbur; smutgrass

Broadleaf Weeds: bittercress[†]; carpetweed; chickweed[†]; geranium, Carolina[†]; henbit; knotweed, prostrate; lespedeza, common[†]; maretail; medic, black; mustard; oxalis, buttercup; pineappleweed; pigweed, redroot; parsley-piert[†]; purslane, common; rocket, London; shepherdspurse; speedwell, corn[†]; spurge, garden; spurge, prostrate; spurge, spotted; woodsorrel, creeping; woodsorrel, yellow

[†] Suppression only

TO REPLACE BATTERIES

- Access the battery compartment on the inside of the spreader base.
- Battery compartment door opens by pinching tab and lifting to open.

Requires 4 AA batteries (included).

Batteries included, but disabled for shipment. Pull tab from battery compartment to activate.

WARRANTY

NOTE To the extent consistent with applicable law, Buyer assumes all responsibility for safety and performance if this product is not used according to the directions.

GUARANTEE

Lebanon Seaboard guarantees you will be satisfied with the performance of this product when used as directed, or your money back. If not satisfied, describe the nature of your problem and simply send proof of purchase to Lebanon Seaboard Corporation, 1600 East Cumberland Street, Lebanon, PA 17042.