

OUTSMARTING RODENTS SINCE 1898.

**1** COMBO  
PACK



Mice & Rats

# RODENT REPELLENT

Plugs Directly into Wall Outlet

**SAFE FOR CHILDREN & PETS\***



**100% Mint**  
Essential Oils

**REPELS MICE & RATS**



\*When used as directed

**FAST-ACTING &**  
Lasts up to  
**45 DAYS**

Scratch  
& Sniff

**Net Contents:**  
0.64 fl oz (19 mL)

**ACTIVE INGREDIENT:**  
Peppermint Oil ..... 100.00%  
**TOTAL** ..... 100.00%

**CAUTION** KEEP OUT OF REACH  
OF CHILDREN

**GREAT FOR GARAGES, BASEMENTS & LARGE SPACES**



# RODENT REPELLENT

Plugs Directly into Wall Outlet

**KNOW MORE!**

Mice can jump a foot into the air, Visit [VictorPest.com/advice](http://VictorPest.com/advice) to learn more.

### INSTRUCTIONS FOR USE

1. Unscrew cap from fragrance bottle.
2. Insert fragrance bottle into warmer by pushing bottle up into device from below until click can be heard.
3. Plug warmer UPRIGHT into outlet. Rotate plug, if necessary. To rotate the plug, hold the front of the unit upright in one hand, grasp both metal plug blades in the other hand and rotate these blades about the center of the plug to which the blades are mounted. To prevent leakage, DO NOT plug in sideways or upside down.
4. To adjust fragrance intensity, push up or down on the button on side of warmer unit. (Up position=max. setting.)

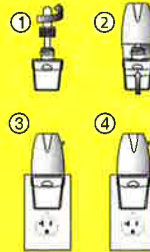

**USER MAINTENANCE:** Fragrance oils may collect on warmer unit over time. To clean warmer unit, remove from electrical outlet and wipe with dry cloth. Replace fragrance bottle when empty, by gently pulling bottle down from unit. DO NOT immerse in water.

**MOVING AND STORAGE:** Remove warmer with refill from wall outlet. Remove refill from warmer and screw cap onto fragrance bottle. Store warmer and refill in a dry location. KEEP OUT OF REACH OF CHILDREN

**CAUTION: EYE IRRITANT.** FIRST AID TREATMENT: If in eyes, rinse with water for 15 minutes. If swallowed, DO NOT induce vomiting. Call a physician or Poison Control Center immediately. Contains fragrance oils. Wash hands after handling. This product is not a toy. Intended for adult use only. Use only in properly functioning 120-volt electrical outlet. DO NOT use with extension cords. To avoid damage, DO NOT place fragrance oil bottle or cap on finished surfaces or place any object within 12" (30 cm) above warmer. DO NOT plug anything in above it. DO NOT disassemble warmer unit or modify the plug in any way. For use with Victor® RatAway Mint Scented Refill bottles. INSTRUCTIONS PERTAINING TO A RISK OF FIRE, ELECTRIC SHOCK OR INJURY TO PERSONS. IMPORTANT SAFETY INSTRUCTIONS - WARNING: When using electric products, basic precautions should always be followed, including the following: a) Read all the instructions before using the product. b) To reduce the risk of injury, close supervision is necessary when a product is used near children. KEEP OUT OF REACH OF CHILDREN. c) DO NOT put fingers, hands, metal, or other foreign objects into the product. d) No user serviceable parts. e) DO NOT attempt to refill fragrance bottle. f) If the warmer unit blocks the "TEST" or "RESET" buttons of a GFCI receptacle, it is recommended that the unit be removed from the unit monthly and the GFCI be tested before plugging the fragrance unit back into the outlet. **SAVE THESE INSTRUCTIONS.**

This product has not been registered by the United States Environmental Protection Agency. Woodstream Corporation represents that this product qualifies for exemption from registration under the Federal Insecticide, Fungicide and Rodenticide Act.



Manufactured For:  
**Woodstream**  
Woodstream Corporation  
69 N. Locust St., Lititz, PA 17543  
855-5-VICTOR  
Model Number: M808  
Net Contents: 1 Refill 1 Plug In  
Rev 0318

